



Roof Renewal System Details

Wall Flashing Detail (With or Without Metal Cap)

1 Deck	2 Existing Membrane
3 New ASC Roof Renewal System Membrane	4 ASC 1 Elastomeric Roof Coating Reinforced with ASC F Polyester Fabric
5 3 Course Installation ASC 7 Elastomagic Cement and ASC F Polyester Fabric	6 Metal Cap Flashing

Wall Flashing Without Metal Cap

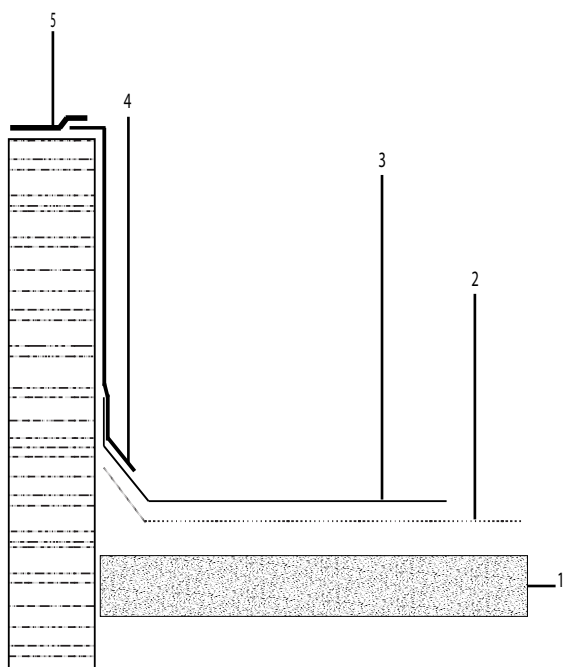

Wall Flashing With Metal Cap

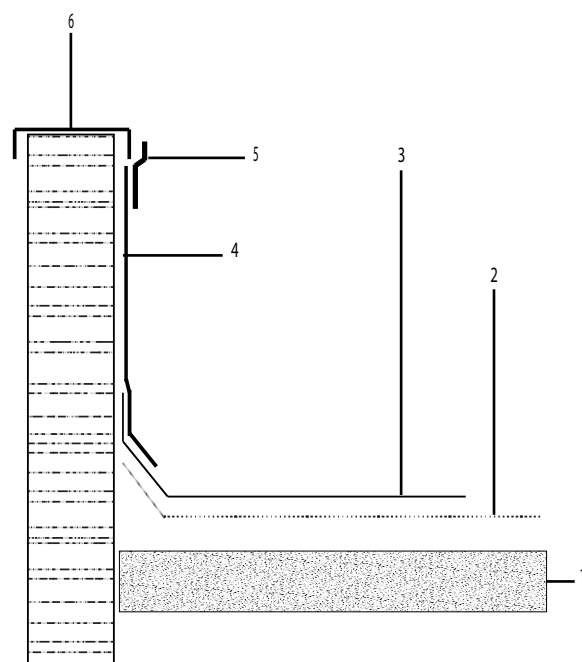

Pre-Application:

Surfaces must be structurally sound, cleaned, dried, and free of moisture on and beneath the surface. Remove all dust, dirt, oil, loose granules and any other foreign contaminants. Remove any other loose, flaking or existing waterproof coatings, which may affect the adhesion. Rusted metal should be cleaned with a wire brush.

Application:

1. Apply 3 Gallons of ASC 1 at approximate rate of 3 gallons per 100 sq. feet,
2. embed ASC F (polyester fabric,)
3. Apply 3 Gallons of ASC 1 at approximate rate of 3 gallons per 100 sq. feet in two passes of 1.5 gallons per pass.
4. Roof to Wall Cant area as needed – Apply first coat of ASC 7 Elastomagic Cement with brush or trowel at 1/8-1/4 inch thickness. Immediately following embed ASC F Polyester Fabric. Lightly brush the polyester fabric into ASC 7 to achieve full saturation, smoothing out wrinkles or voids. Apply second coat of ASC 7 Elastomagic Cement.

Existing Metal Cap in place - Apply first coat of ASC 7 Elastomagic Cement with brush or trowel at 1/8-1/4 inch thickness. Immediately following embed ASC F Polyester Fabric. Lightly brush the polyester fabric into ASC 7 to achieve full saturation, smoothing out wrinkles or voids. Apply second coat of ASC 7 Elastomagic Cement. The area of coverage is interior edge of Metal Cap.

Wall Flashing Without Metal Cap - Apply first coat of ASC 7 Elastomagic Cement with brush or trowel at 1/8-1/4 inch thickness. Immediately following embed ASC F Polyester Fabric. Lightly brush the polyester fabric into ASC 7 to achieve full saturation, smoothing out wrinkles or voids. Apply second coat of ASC 7 Elastomagic Cement. The area of coverage is the parameter in its entirety.

